

iYGEC6

The 6th International Young Geotechnical
Engineers' Conference

Sep. 16 - 17, 2017

GECE, Seoul National University, Seoul, Korea

Program Book



International Society for
Soil Mechanics and Geotechnical Engineering



Korean Geotechnical Society

iYGEC6

The 6th International Young Geotechnical Engineers' Conference

CONTENTS

iYGEC6 Local Organizing Committee	01
Program at a Glance	02
Program	
Day 1 / Sep. 16, 2017	03
Day 2 / Sep. 17, 2017	09
Conference & General Information	
Conference Information	15
General Information	16
Venue Map	18

iYGEC6 LOCAL ORGANIZING COMMITTEE

CHAIR Moonkyung CHUNG
Korea Institute of Civil Engineering and Building Technology

SCIENTIFIC COMMITTEE

CHAIR Tae Sup YUN
Yonsei University

MEMBERS Han-Saem KIM
Korea Institute of Geoscience and Mineral Resources

Joonkyu LEE
University of Seoul

Jae-Hyun PARK
Korea Institute of Civil Engineering and Building Technology

Hoonil SEOL
SK E&C

Hyu-Soung SHIN
Korea Institute of Civil Engineering and Building Technology

SOCIAL PROGRAM COMMITTEE

CHAIR Duhee PARK
Hanyang University

MEMBERS Wanjei CHO
Dankook University

Hyunwook CHOO
Kyunghee University

Dongwook KIM
Incheon National University

Hyung-Koo YOON
Daejeon University

PROGRAM AT A GLANCE

	Sep. 16 (Sat)		Sep. 17 (Sun)	
	Room 520	Room 517	Room 520	Room 517
09:00	Opening Ceremony		Slope Stability (II)	Excavation
	Keynote Lecture 1			
10:00	Break		Break	
11:00	Foundations (I)	In-situ Investigation and Characterization	Soil Behaviors and Characterization (III)	Liquefaction
	Break			
12:00	Soil Behaviors and Characterization (I)	Ground Improvement	Lunch	
13:00	Lunch		Keynote Lecture 2	
14:00			Foundations (II)	Rock Mechanics & Tunneling
15:00	Slope Stability (I)	Soil Dynamics	Break	
	Break		Engineered Soil	Energy Geotechnics and Sustainability
16:00	Soil Behaviors and Characterization (II)	Geotechnical Practices	Closing Ceremony	
17:00				
18:00				
19:00	iYGE6 Dinner		19 th ICSMGE Welcome Reception	
20:00				

iYGE6 Dinner

All participants are cordially invited to the iYGE6 Dinner

DATE & TIME Sep. 16, 19:00-21:00

LOCATION Rakgujung, GECE (B1F)

19th ICSMGE Welcome Reception

All participants are cordially invited to the 19th ICSMGE Welcome Reception

DATE & TIME Sep. 17, 19:00-21:00

LOCATION Auditorium Lobby, COEX (3F)

* Shuttle Bus will departure at GECE Lobby(1F), 17:30

PROGRAM

Day 1 | Sep. 16, 2017

OPENING CEREMONY & KEYNOTE LECTURE 1

Sep. 16 (Sat), 09:00-10:00 / Room 520

09:00-09:15 **Opening Ceremony**

OPENING ADDRESS Moonkyung Chung, Chair of iYGE6, Korea

WELCOME ADDRESS 1 Roger Frank, President of ISSMGE, France

WELCOME ADDRESS 2 Sangseom Jeong, President of Korean Geotechnical Society, Korea

09:15-10:00 **Keynote Lecture 1**

CHAIR Young-Hoon Jung, Kyunghee University, Korea

CO-CHAIR Byeongsu Kim, Okayama University, Japan

KEYNOTE LECTURER **Integrated system for site-specific earthquake hazard assessment with geotechnical spatial grid information based on GIS**
Choong-Ki Chung, Seoul National University, Korea

FOUNDATIONS (I)

Sep. 16 (Sat), 10:10-11:30 / Room 520

CHAIR Hoonil Seol, SK E&C, Korea

CO-CHAIR Joonkyu Lee, University of Seoul, Korea

SPEAKER **Optimization of driveability predictions for large diameter monopiles in London clay**
Christopher Morris, BGGG-GBMS, Belgium

Laterally loaded deep foundations associated with treated soils

Vitor Pereira Faro, Federal University of Parana, Brazil

Analysis of static load tests of piles created by different technologies

Jakub Stacho, Slovak University, Slovakia

Settlement prediction of footings considering stress history based on Vs

Hyung-Ik Cho, KAIST, Korea

Systematically interpreting process parameters and the quality of pile foundations

Ana Teixeira, Deltares, The Netherlands

An optimal pile foundation construction for skyscrapers

Stanislav Shulyatev, NIIOSP, Russia

Response of bucket foundations under cyclic loading

Jeong-Seon Park, Korea Hydro & Nuclear Power Central Research Institute, Korea

IN-SITU INVESTIGATION AND CHARACTERIZATION

Sep. 16 (Sat), 10:10-11:30 / Room 517

CHAIR Guillermo Andres Narsilio, The University of Melbourne, Australia

CO-CHAIR Hyunwook Choo, Kyunghee University, Korea

SPEAKER Estimating groundwater level based on observed precipitation data
Incheol Kim, Yonsei University, Korea

Comparison of CPT response and physical classification data for a North Sea sand deposit for evaluation of accuracy of indirect soil classification
Frederik Ancker Agergaard, Ramboll, Denmark

Measurement of stresses and pore pressures during cone penetration in silt
Priscilla Paniagua, Norwegian Geotechnical Institute, Norway

Instrumented dynamic cone penetrometer: development and applications
Yong-Hoon Byun, Kyungpook National University, Korea

The investigations of interaction of boring piles with soil ground of coastal area of Caspian Sea
Abdulla R. Omarov, Eurasian National University, Kazakhstan

Logistic regression on sewer pipe characteristics and sinkhole occurrences
Joonyoung Kim, Seoul National University, Korea

Landslide susceptibility mapping using geomatics: a case study of murree area, Pakistan
Menal Zaheer, NESPAK, Pakistan

SOIL BEHAVIORS & CHARACTERIZATION (I)

Sep. 16 (Sat), 11:40-13:00 / Room 520

CHAIR Jang-Guen Lee, KICT, Korea

CO-CHAIR Bate Bate, Zhejiang University, China

SPEAKER Destroying the structure of halloysite clay through oven drying
Christopher Lenthall, Golder Associates Pty Ltd., Australia

Numerical modelling of heavily overconsolidated clay till using brick
Emil Mejlhede Kinslev, Danish Geotechnical Society, Denmark

Reconsidering the effect of fines content on the behavior of non-plastic soils
Luis Alberto Torres-Cruz, University of Witwatersrand, South Africa

Wave velocities in Mexico valley clays under the influence of different consolidation stress paths
Rogelio Vazquez, UNAM, Mexico

Evaluation of creep behavior prediction model on frozen sand considering fine contents
Bumsik Hwang, Dankook University, Korea

Effect of soil treatment and mixing on the dispersive behavior of soils
Gábor Nagy, Budapest University, Hungary

State-dependent volumetric creep behavior
Ka-Hyun Park, Kyunghee University, Korea

GROUND IMPROVEMENT

Sep. 16 (Sat), 11:40-13:00 / Room 517

CHAIR Jae-Hyun Park, KICT, Korea

CO-CHAIR Joonkyu Lee, University of Seoul, Korea

SPEAKER Investigation of soil-machine interaction during deep vibro compaction
Péter Nagy, Vienna University, Austria

Improvement of soft clay soils by vertical reinforcing drain elements
Tatiana Tronda, Belarusian National Technical University, Belarus

Improvement of weak lateritic subgrade soil for low volume road construction using coconut fibers
Augustine Korli Lawer, KNUST, Ghana

Comparison between predicted and actual ground settlement improved using stone columns

Khong Siong Chee, Gamuda Engineering Sdn Bhd, Malaysia

Evaluation of the jet-grouting material parameters conducted in soft soil based on probabilistic analysis

Aleksandra Chepurnova, NIIOSP, Russia

High reinforced soil structures in a mountainous and seismically active region in Luzon, Philippines

John Michael Gargullo, AMH Philippines, Inc., Philippines

Analysis of complex tests on precast concrete joint pile

Karlygash Borgekova, Gumilyov Eurasian National University, Kazakhstan

SLOPE STABILITY (I)

Sep. 16 (Sat), 14:30-15:50 / Room 520

CHAIR Ilhan Chang, University of New South Wales, Australia

CO-CHAIR Hyung-Koo Yoon, Daejeon University, Korea

SPEAKER **Numerical analysis of the stability of soil slopes considering unsaturated conditions by using a Lysimeter-data calibrated model**
Patrick P. Pichler, Graz University of Technology, Austria

Stability of clay slopes using piles : numerical study
Mohamed Sobhey, Tanta University, Egypt

Large-scale model tests on various reinforcement technologies of river levee against overflow erosion
Yuki Kurakami, Tokyo University of Science, Japan

Case study: seismic analysis for slope stability of a very high waste rock dump
Lyn Mantilla, Universidad Nacional de Ingenieria, Peru

Internal erosion in low plasticity cores of embankment dams
Diego Escudero, Technical University of Madrid, Spain

The material point method in slope stability analysis
Francesc Mirada, Arup, UK

Geotechnical assessment to inform Gibraltar Eastside rockfall simulation
Louis Kingdom, Golder Associates, UK

SOIL DYNAMICS

Sep. 16 (Sat), 14:30-15:50 / Room 517

CHAIR Jin-Tae Han, KICT, Korea

CO-CHAIR Hoonil Seol, SK E&C, Korea

SPEAKER **Large-scale landslide analysis subjected to the 2016 Kumamoto earthquakes**
Ching Hung, National Cheng Kung University, Taiwan

Improvement of anisotropically consolidated clays using columnar sand inclusions
Ahmad Kahiel, American University of Beirut, Lebanon

Assessment of seismic interaction between a crusher and a MSE wall in Peru
Erick Lino, SRK Consulting, Peru

Study of the dynamic properties of a remolded clay specimen investigated in a modified resonant column
Emil Soból, Warsaw University of Life Sciences – SGGW, Poland

Design of a novel laminar box for evaluating the seismic performance of soils
Cihan Cengiz, Bogaziçi University, Turkey

Observations and finite element modeling of the Aso Caldera depression zone resulting from the 2016 Kumamoto earthquake
Nicolas K. Oettle, AECOM, USA

Evaluation of seismic behavior of disconnected pile foundation via dynamic centrifuge tests
Jeong-Gon Ha, KAIST, Korea

SOIL BEHAVIORS & CHARACTERIZATION (II)

Sep. 16 (Sat), 16:00-17:20 / Room 520

CHAIR Jaewon Jang, Hanyang University, Korea

CO-CHAIR Han-Saem Kim, KIGAM, Korea

SPEAKER **Numerical modelling of large post-liquefaction shear deformation of sand**
Rui Wang, Tsinghua University, China

Evaluation of the small strain shear modulus of the dry sands with different fines content
Jakub Panuška, Slovak University, Slovakia

In search for realistic tests for determination of durability of waste rock as construction material from metallic mineral deposits

Elena Angelova, Geohydroconsulting, Macedonia

Influence of microstructural characteristics on the strength of granular media

Jesús Sánchez, Instituto de Ingeniería UNAM, Mexico

Study of expansive clayey sand (SC) soil in Sudan

Haitham Shammatt, Dar Al Riyadh Consultants, Sudan

Estimation of drained shear strength of granular soil from shear wave velocity and confining stress

Jin-Kwon Yoo, Hanyang University, Korea

Predictive models for the determination of settlement parameters of cohesive soils in the Niger Delta region of Nigeria

Godfrey Jaja, Rivers State University of Science and Technology, Nigeria

GEOTECHNICAL PRACTICES

Sep. 16 (Sat), 16:00-17:20 / Room 517

CHAIR Wanjei Cho, Dankook University, Korea

CO-CHAIR Dongwook Kim, Incheon National University, Korea

SPEAKER **Earthmoving through the lens of geotechnical engineering**

James Hambleton, Northwestern University, USA

Application of BIM in geotechnics – case study on a deep excavation project

Chriswini Tanaka, Arup Singapore, Singapore

Evaluation of soil disturbances due to the installation of a suction bucket on sand using centrifuge model tests

Jae-Hyun Kim, KAIST, Korea

The state of abrasive waterjet technologies for construction in Korea

Yohan Cha, KAIST, Korea

The use of geosynthetic reinforced pile-supported embankments on port mann highway 1 improvement project

Andrea Lougheed, Thurber Engineering Ltd., Canada

Static failure mechanisms in sensitive volcanic soils in the bay of plenty region, New Zealand

Philippa Mills, Coffey Geotechnics (NZ) Ltd., New Zealand

Day 2 | Sep. 17, 2017

SLOPE STABILITY (II)

Sep. 17 (Sun), 09:00-10:20 / Room 520

CHAIR Yu-Hsing Wang, The Hong Kong University of Science and Technology, Hong Kong

CO-CHAIR Ilhan Chang, University of New South Wales, Australia

SPEAKER **Effects of random measurement error on the genetic algorithm in soil parameter identification for an earth- and rockfill dam**

Jasmina Toromanovic, Luleå University, Sweden

Remote sensing supported surveillance of tailings dams and impoundments: a case study of a Finnish paste tailings impoundment

Anssi Rauhala, University of Oulu, Finland

Non-destructive method for evaluating installed lengths of soil nails using electromagnetic waves

Jung-Doung Yu, Korea University, Korea

Interaction of marginal fills and geogrids for reinforced soil walls and slopes

Anil Ekici, Middle East Technical University, Turkey

Friction tests on clayey soils for fast and bouncy cricket pitches in Sri Lanka

Sahan Perera, University of Moratuwa, Sri Lanka

Soil classification of the northwest region of the state of rio grande do sul by MCT methodology

Nicole Callai, Regional University of Noroeste Estado do Rio Grande do Sul – UNIJUÍ, Brazil

EXCAVATION

Sep. 17 (Sun), 09:00-10:20 / Room 517

CHAIR Seunghee Kim, University of Nebraska, USA

CO-CHAIR Byeongsu Kim, Okayama University, Japan

SPEAKER **Three dimensional effect of discontinuous berms for enhancing the performance of diaphragm walls**

Muhammad M. El-Sherbiny, Dar Al-Handasah, Egypt

Investigations on the safety against hydraulic failure of excavation pits with consideration of adhesion

Nicholas Andermahr, RWTH Aachen University, Germany

Design and construction of an unbalanced excavation near historical structures with bored piles as retaining structure in Hong Kong

Lucy Wu, HNTB, Hong Kong

Observed behaviour of a deep excavation in Shanghai soft clays

Fabiano Bertoldo, Sapienza Università di Roma, Italy

Design of a heavy-duty deep sea quay wall for offshore wind energy

Jan Putteman, BGGG-GBMS, Belgium

Prediction of ground settlement of deep excavation works adjacent to operating railway tracks in Hong Kong

Ceres Man Yui Chung, Ove Arup & Partners Hong Kong Ltd., Hong Kong

Deformation capacity of slurry walls and their water retaining capacity – a project description

Klaas Siderius, Fugro GeoServices, The Netherlands

SOIL BEHAVIORS & CHARACTERIZATION (III)

Sep. 17 (Sun), 10:30-11:50 / Room 520

CHAIR Guillermo Andres Narsilio, The University of Melbourne, Australia

CO-CHAIR Tae-Hyuk Kwon, KAIST, Korea

SPEAKER **The tensile strength of soils built-in landfill mineral sealing layers**

Mariola Wasil, Bialystok University, Poland

The examination of different soil parameters' coefficient of variation values and types of distributions

Istvan Kadar, Budapest University, Hungary

Modelling of permeability in stratified soil using wave propagation method

Anjan Patel, Visvesvaraya National Institute of Technology, India

Hambly's paradox and the practicing geotechnical engineer: a study of the robustness of lateral soil loads

David Buxton, Hawthorn Geddes Engineers & Architects, New Zealand

Effects of compaction on lateral earth pressure

Jean Potgieter, University of Pretoria, South Africa

The shrinkage of invading CO₂ phase by capillary end effect in the drainage modeling for geological microfluidic chip geometry by lattice Boltzmann method

Donghun Kang, Yonsei University, Korea

LIQUEFACTION

Sep. 17 (Sun), 10:30-11:50 / Room 517

CHAIR Jin-Tae Han, KICT, Korea

CO-CHAIR Taeseo Ku, National University of Singapore, Singapore

SPEAKER **Prevention of liquefaction of transported ores in bulk carriers**

Samar Daoud, Universite de Tunis el Manar, Tunisia

Field -testing liquefaction models based on geospatial vs. geotechnical data

Brett Maurer, Virginia Polytechnic Institute & State University, USA

Simulating the seismic response of geostructures after passive stabilization against liquefaction

Georgia I. Agapoulaki, University of Thessaly, Greece

Investigating the effects of particle shape on liquefaction resistance of sands from critical state perspective

Xiao Wei, The University of Hong Kong, Hong Kong

Site-specific comparison and evaluation of empirical liquefaction potential assessment methods

Zoltán Bán, Budapest University, Hungary

KEYNOTE LECTURE 2

Sep. 17 (Sun), 13:05-13:50 / Room 520

CHAIR Wanjei Cho, Dankook University, Korea

CO-CHAIR Bate Bate, Zhejiang University, China

KEYNOTE LECTURER **Ethics and Leadership**
Za-Chieh Moh, MAA Group, Taiwan

FOUNDATIONS (II)

Sep. 17 (Sun), 13:50 -15:10 / Room 520

- CHAIR** Jongwon Jung, Chungbuk National University, Korea
- CO-CHAIR** Taeseo Ku, National University of Singapore, Singapore
- SPEAKER** **Evaluation of triangular pile arrangement through a numerical study of the light embankment piling method**
Per Gunnvard, Luleå University, Sweden
-
- The method for determining bored piles load-bearing capacity, taking into account the direction of vertical loading in water-saturated soils**
Sergii Tabachnikov, O.M. Beketoc National University, Ukraine
-
- Influence factors on the degree of soil plugging for open-ended piles**
Junyoung Ko, Texas Tech University, Korea
-
- Recurrence plot in the interpretation of pile integrity test**
Jessica Romero, Benemérita Universidad Autónoma de Puebla, Mexico
-
- Dynamic analysis methods of horizontally vibrating pile foundations**
Janne Juuti, Tampere University, Finland
-
- Settlement analysis of a building supported by raft foundation using 3D numerical modelling**
Truong Hoang Minh, Golder Associates, Singapore
-
- Analysis of skin friction behavior in prebored and precast piles based on field loading test using proposed t-z curve**
Dohyun Kim, Yonsei University, Korea

ROCK MECHANICS & TUNNELING

Sep. 17 (Sun), 13:50 -15:10 / Room 517

- CHAIR** Hyu-Soung Shin, KICT, Korea
- CO-CHAIR** Jongwan Eun, University of Nebraska, USA
- SPEAKER** **Design consideration for shallow urban tunnels in weak / soft ground conditions**
Jeffrey Oke, Mine Design Engineering, Canada
-
- Elaboration of thick shells theory for the application of convergence confinement method, for dimensioning of deep and shallow tunnels in anisotropic stress field**
Guillaume Champagne de Labriolle, Arcadis ESG, France

Tunnelling induced ground settlement during the construction of a deep drainage tunnel in an urban area in Hong Kong

Eugene K. L. Wong, HKSAR Government, Hong Kong

Numerical verification of tensile stress development in highly fractured phyllite characterised via pressuremeter test

F. Phangkawira, Swinburne University, Malaysia

Calculation of horizontal ground movements due to tunnel construction using empirical and numerical methods

Anas Mohamed, Khartoum University, Sudan

Tunnel forecasting method using electromagnetic waves

Chang-Ho Hong, KAIST, Korea

Consideration of scaling effects in the deformation analysis of high rockfill dams

Raksiri Sukkarak, King Mongkut's University, Thailand

ENGINEERED SOIL

Sep. 17 (Sun), 15:20-16:40 / Room 520

- CHAIR** Yu-Hsing Wang, The Hong Kong University of Science and Technology, HongKong
- CO-CHAIR** Tae-Hyuk Kwon, KAIST, Korea
- SPEAKER** **Relation between microstructural properties and strength parameters of biocemented sands**
Abdelali Dadda, Université Grenoble Alpes, France
-
- Compressibility characteristics of coconut fiber reinforced lateritic subgrade soil**
Denise Samuella Boadu, KNUST, Ghana
-
- Strength and deformation behavior of municipal solid waste**
Sandeep K Chouksey, National Institute of Technology Raipur, India
-
- Prediction of shear strengths parameters and its application in soil-lime mixture design**
Marta Di Sante, Università Politecnica delle Marche, Italy
-
- Modeling the mechanical behavior of sand-cement mixtures**
Daniel Ribeiro, CERIS, Portugal

Utilization of boiler slag as fill material for geotechnical applications

Jasna Smolar, University of Ljubljana, Slovenia

A laboratory experiment on the resistivity tomography applicable to TBM

Kang-Hyun Lee, Korea Expressway Corporation, Korea

ENERGY GEOTECHNICS AND SUSTAINABILITY

Sep. 17 (Sun), 15:20-16:40 / Room 517

- CHAIR** Jongwan Eun, University of Nebraska, USA
- CO-CHAIR** Seunghye Kim, University of Nebraska, USA
- SPEAKER** **Conservation of historical tumulus mounds using geotechnical engineering techniques**
Mai Sawada, Kyoto University, Japan
-
- Preliminary thermal response analysis of a heat storage system**
Tugce Baser, University of California San Diego, USA
-
- Punctuated equilibrium and policy diffusion: an application to energy foundations**
Fikret Atalay, Georgia Institute of Technology, USA
-
- Experimental investigation of CO₂ rich brine multi-phase flows: application to CO₂ geological sequestration**
Yeonjong Jeong, Yonsei University, Korea
-
- Micro-hydrromechanical modeling of piping erosion processes**
Ignacio González-Tejada, Technical University of Madrid, Spain
-
- Stability assessment of foundations in the oil and gas marginal fields of Niger Delta**
Will Ibim Beresibo, University of Port Harcourt, Nigeria
-
- The construction in the beach of durres and sustainable development**
Egi Bozo, 47 EK 79 & ILIRIADA P.K.S shpk, Albania

CLOSING CEREMONY

Sep. 17 (Sun), 16:40-17:00 / Room 520

- DECLARATION** Duhee Park, Hanyang University, Korea
- CONFERENCE REPORT** Tae Sup Yun, Yonsei University, Korea
- CLOSING ADDRESS** Moonkyung Chung, Chair of iYGEC6, Korea

CONFERENCE & GENERAL INFORMATION

Conference Information

VENUE

Global Education Center for Engineers (GECE, Bldg. No. 38), Seoul National University, Seoul, Korea

REGISTRATION DESK

All participants of iYGEC6 are required to check-in at the Registration Desk.

LOCATION 5F, Global Education Center for Engineers (GECE), Seoul National University

OPERATING HOURS Sep. 16, 2017 08:00-18:00
Sep. 17, 2017 08:00-18:00

* On-site Registration is not available.

* Program book, transportation card, USB flash driver containing the proceedings, and certificate of attendance will be given at the registration desk.

* Registration for 19th ICSMGE will be available at COEX.

SECRETARIAT • PREVIEW ROOM

LOCATION Room 522 (5F), GECE

OPERATING HOURS Sep. 16 -17, 2017 08:00-18:00

* Speakers can use the Preview Room to prepare and check the presentation files at least 2 hours prior to your session time.

LUNCH • COFFEE BREAKS

LOCATION Foyer (5F), GECE

OPERATING HOURS Sep. 16, 2017 09:30 / 13:00 / 15:30
Sep. 17, 2017 09:30 / 11:50 / 15:00

LANGUAGE

The official language of iYGEC6 is English.

WI-FI SERVICE

Free WiFi will be available during the conference.

ID: iygec520 / iygec517 PW: 123456789

19th ICSMGE MOBILE APP

Get the 19th ICSMGE App for your smartphone now and experience the conference at your fingertips. The app contains session information and social programs so you are always kept up to date on conference news.

The app is free and can be downloaded on all smartphones and tablet devices.

SHUTTLE SERVICE

The shuttle will be provided between Gangnam Family Hotel & Hotel Sam Jung and GECE, the venue. Be sure to stand by at the Lobby at least 5 minutes before departure.

Sep. 16	Hotel → GECE	07:30
	GECE → Hotel	21:00
Sep. 17	Hotel → GECE	07:50
	GECE → COEX	17:30

General Information

LOCAL TIME

GMT +9 hours

BANKS / ATM(AUTOMATED TELLER MACHINES)

Banks are open Monday through Friday from 9am to 4pm. ATM service is typically available until 10pm although, some ATMs offer service after 10pm for an additional fee.

ELECTRICITY

The standard voltage in Korea is 220volts and the outlet has two round holes.

RESTAURANTS

Most shops and restaurants in Seoul are open from 10am to 10pm on weekdays and until 11pm on weekends.

EMERGENCY FIRST AID

In case of emergency, please contact the local secretariat staff (#522) or the registration desk. The staff will be on hand to assist.

T-MONEY



T-money is a transportation card as well as a device used to pay for transportation fares (bus, metro, taxi), and, in some cases, transactions at some stores. It offers 100 won off the basic cash fare, and still more when transferring from one bus to another, one subway line to another, or from bus to subway or vice versa (within a transfer time limit).

- Re-Chargeable from 1,000 won.
- [10,000 won is already charged in the card for iYGEC6 Participants.](#)
- Refund
 - All convenience stores
Under 30,000won, it charges commission (500won).
 - Subway station
Under 50,000won, it charges commission (500won).
 - * Card is non-refundable.

CURRENCY

The unit of currency in Korea is the Korean Won(KRW). As of September 2017, the exchange rate is approximately 1 USD to 1,150 KRW.

All banks are available for exchange money. There is the exchange counter nearby COEX.

USEFUL PHONE NUMBERS

Police	112
Fire and Ambulance	119
Medical Referral Service	1339
Interpretation Service	1588-564
Tourist Information Helpline	1330

VENUE MAP

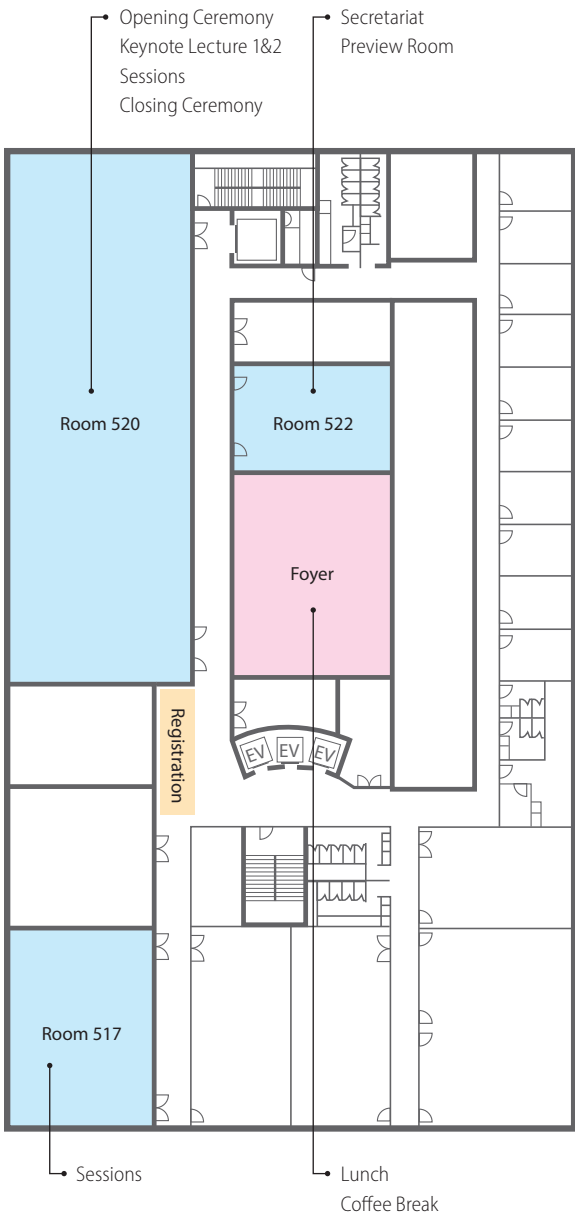

NOTE

iYGEC6

The 6th International Young Geotechnical
Engineers' Conference



iYGEC6 Secretariat

TEL. +82-2-6288-6341 **FAX.** +82-2-6288-6933 **E-MAIL.** iYGEC@icsmge2017.org
4F, SUNGJI Building, 192, Bangbae-ro, Seocho-gu, Seoul, Korea